

SHEC Eco-Retreat Center

Consultancy / Professional services

Location : Norzagaray, Bulacan
Date : January to May 2010
Client : Saint Hannibal Empowerment Center (SHEC)

Project partners

- SHEC

Funding support

- SHEC

Contract / agreement value

- PHP 22,737.75

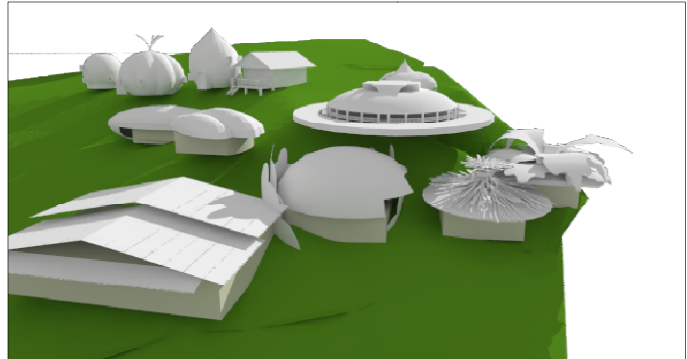

Three-dimensional building massing studies of the various buildings in the eco-retreat center

Project brief

In 2009, the Rogationist priests of St. Hannibal Empowerment Center (SHEC) requested for the conceptual master planning and building schematic designs of its proposed Eco-Retreat Center within a 4-hectare ecology and demonstration farm in Norzagaray, Bulacan. TAO-Pilipinas developed the conceptual master plan for the SHEC Eco-Retreat Center which was classified into four land use zones – an ecological farm, a retreat zone, a conference facility zone, and a pilgrimage zone.

Ocular visits to the site were conducted with student interns who also developed concept drawings for the different building designs in the various zones of the eco-retreat center. The overall architectural design theme for the building forms took inspiration from the organic shape of various local vegetable and fruit crops.

The conceptual master plan and building designs were completed. Moving forward to details was set aside until funding was secured. To date, the plan has not yet to be realized, but the demonstration farm is being sustained.

Project outputs

- Conceptual master plan
- Architectural concept drawings

{ End of Project **0904** Profile }